

ENGINEERING — ARCHITECTURE — SURVEYING
7 RIDGWAY COURT — P.O. BOX 437 — ELKHORN, WISCONSIN 53121
PHONE: (262) 723-2098 FAX: (262) 723-5886

LOT 121 OF ELKHORN WEST ADDITION NO. 2
LOCATED IN PART OF THE NE 1/4 OF THE SE 1/4 OF SECTION 35,
TOWN 2 NORTH, RANGE 16 EAST, CITY OF ELKHORN, WALWORTH COUNTY, WISCONSIN

SUBDIVISION PLAT
BEARING BASIS

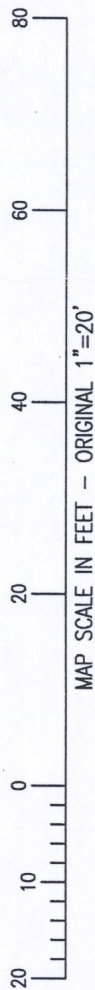

RECEIVED
FEB 19 2018
By Jan

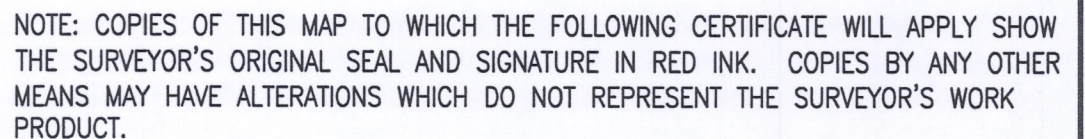

DATED: 01/11/2018

PRO.#: 6103.02.121
DATE: 09/12/2005
SHEET 1 OF 1

004-2639